



One BIN only
for a CCT range



Lifetime



Certified



Certified



Certified



Warranty

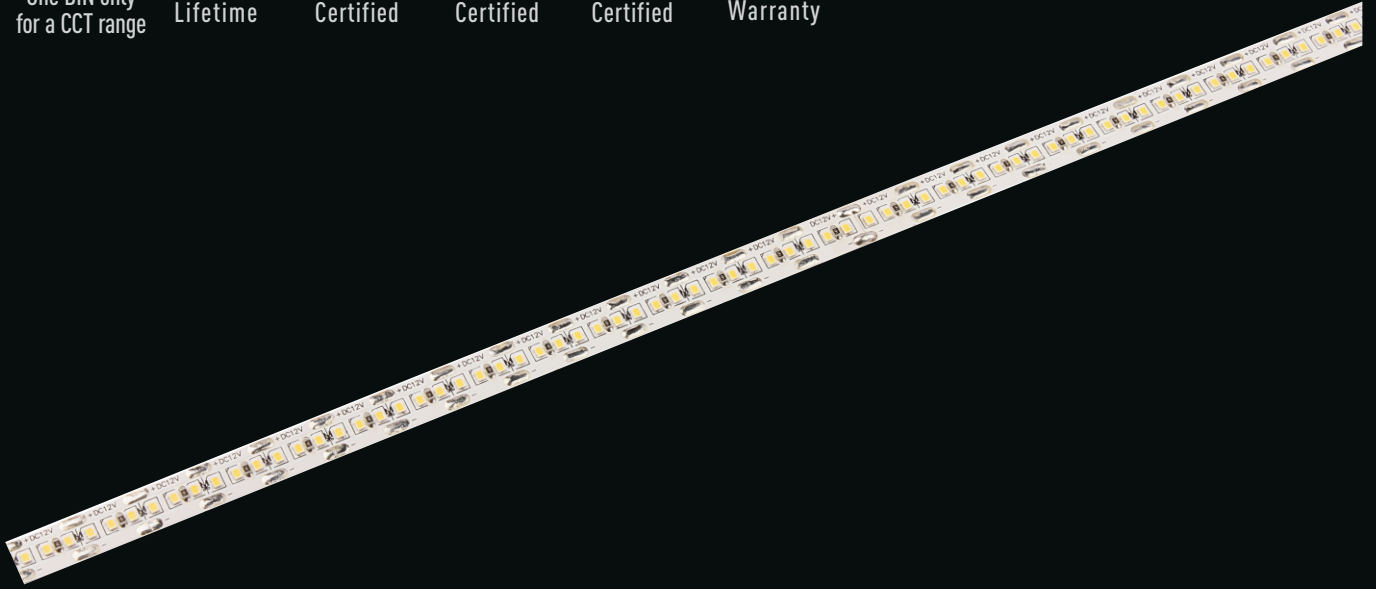

Ra Available

IP Grade Available



Features

- Super bright 2016 LEDs
- Epistar chips, LM-80 tested
- Ra90+, with high R9 & R13 value
- Wide color temperature range, one bin only for one CCT
- Silicone extrusion (IP68), tube encased (IP67), silicone coated (IP65) & indoor (IP22) are available
- Cuttable every 3 LEDs
- 3M double sided tape for easy installation
- cULus Listed, 5 years warranty



BLUEVIEW ELEC-OPTIC TECH CO.,LTD

Tel: +86-28-8148 0011 Fax: +86-28-8148 1258
 Mail: sales@blueviewled.com Web.: www.blueviewled.com
 Add: No.1000, Section 2, 2nd Konggang Road, Southwest
 Aviation Industrial Development Zone, Chengdu,Sichuan, China.
 Zip code: 610207

Specifications are subject to change without notice.
 ©Blueview™ 2016 – All rights reserved. Made in China.

Specifications

LED Type	SMD 2016	Dimmable	Yes (compatible with BV311 RF dimmer & BV Dimmer)
LED Q'ty/m	240pcs	IP grade	IP22 (IP65 & IP67 & IP68 available upon request)
Input Voltage	12V DC Constant Voltage	Installation	3M™ double sided tape (mounting clips for IP68)
Power	17.28W	Working Temperature	-25~+60℃
Cutting length	12.5mm 3 LEDs	Max run	2.5 meters
Strip Width	10mm	Certification	E354137 cULus Listed, CE, RoHs
Viewing Angle	120°	Warranty	5 years ^①

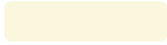
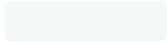
Order Code	CCT/ Color	CRI	Lumen/M ^②
FN-2016A-240-12-27K	 2645-2800K	90+	1280
FN-2016A-240-12-30K	 2850-3025K	90+	1380
FN-2016A-240-12-42K	 3840-4060K	90+	1440
FN-2016A-240-12-50K	 4830-5095K	90+	1480
FN-2016A-240-12-65K	 6170-6820K	90+	1480

Note^①: Contact Blueview for exact warranty period and policy

Note^②: Lumen output are based on CRI80+ measured according to PMS-80, with a tolerance of +/- 5%

Note^③: Standard package: 5m/roll

Order Code

Model	Quality level	LED Q'ty/M	Input voltage	CCT/Color
FN	2016A	240	12	25K
FN-IP22 FWS-IP65 FWT-IP67 FWE-IP6	2016A-5 yrs warranty		12-12V DC	view table above for options

BLUEVIEW ELEC-OPTIC TECH CO.,LTD

Tel: +86-28-8148 0011 Fax: +86-28-8148 1258
 Mail: sales@blueviewled.com Web.: www.blueviewled.com
 Add: No.1000, Section 2, 2nd Konggang Road, Southwest
 Aviation Industrial Development Zone, Chengdu, Sichuan, China.
 Zip code: 610207

Specifications are subject to change without notice.
 ©Blueview™ 2016 – All rights reserved. Made in China.

Dimension

Unit:mm[in]

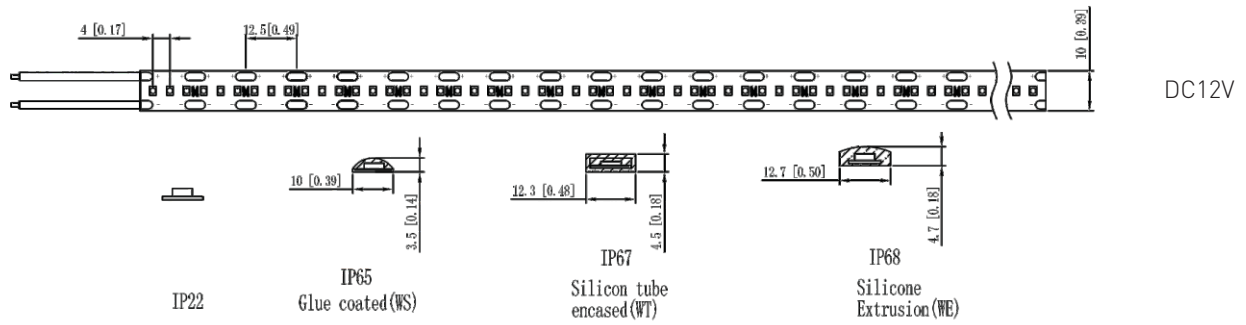

Package

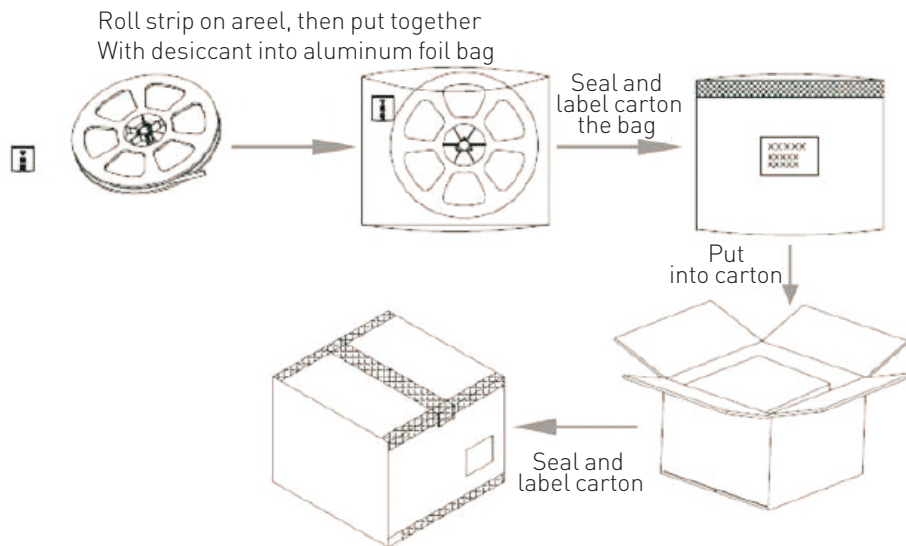

Packing Info

Order Code	Net Weight / CTN	Gross Weight / CTN	Units / CTN	Carton Size
FN-2016A-240-12	12.0 (1±10%) kgs	15.0 (1±10%) kgs	100 rolls	550*400*340mm
FWS-2016A-240-12	25.0 (1±10%) kgs	26.0 (1±10%) kgs	100 rolls	550*400*340mm
FWT-2016A-240-12	25.0 (1±10%) kgs	26.0 (1±10%) kgs	100 rolls	550*400*340mm
FWE-2016A-240-12	30.0 (1±10%) kgs	32.0 (1±10%) kgs	60 rolls	550*400*340mm

BLUEVIEW ELEC-OPTIC TECH CO.,LTD

Tel: +86-28-8148 0011 Fax: +86-28-8148 1258
 Mail: sales@blueviewled.com Web.: www.blueviewled.com
 Add: No.1000, Section 2, 2nd Konggang Road, Southwest
 Aviation Industrial Development Zone, Chengdu,Sichuan, China.
 Zip code: 610207

Specifications are subject to change without notice.
 ©Blueview™ 2016 – All rights reserved. Made in China.



One BIN only
for a CCT range



Lifetime



Certified



Certified



Certified



Warranty

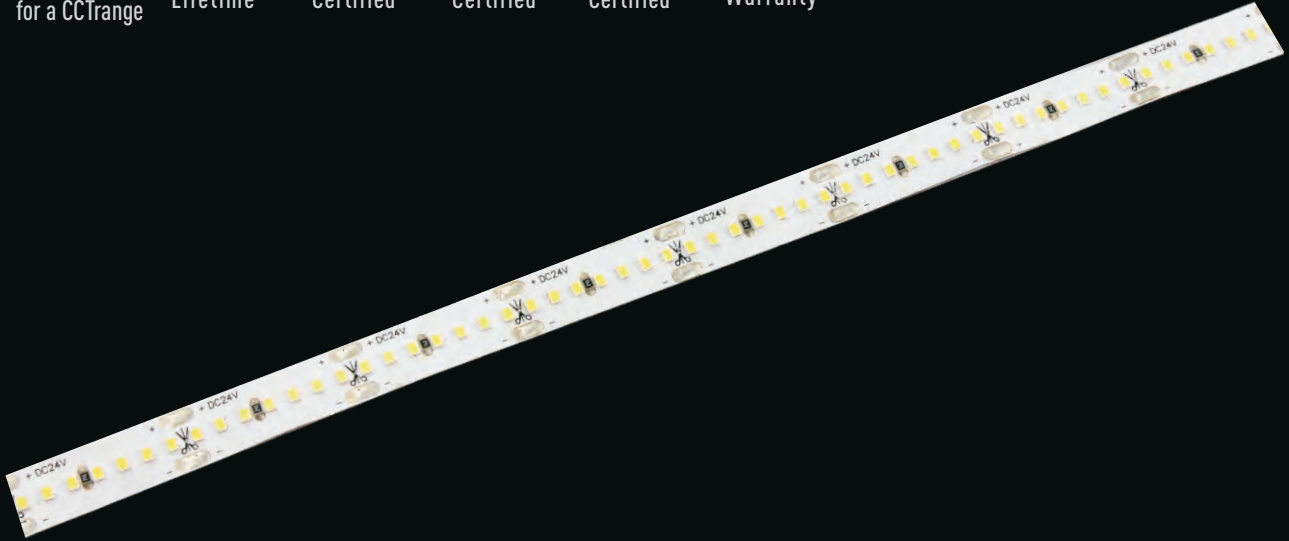

Ra Available

IP Grade Available



Features

- Super bright 2016 LEDs
- Epistar chips, LM-80 tested
- Ra90+, with high R9 & R13 value
- Wide color temperature range, one bin only for one CCT
- Silicone extrusion (IP68), tube encased (IP67), silicone coated (IP65) & indoor (IP22) are available
- Cuttable every 7 LEDs
- 3M double sided tape for easy installation
- cULus Listed, 5 years warranty



BLUEVIEW ELEC-OPTIC TECH CO.,LTD

Tel: +86-28-8148 0011 Fax: +86-28-8148 1258
 Mail: sales@blueviewled.com Web.: www.blueviewled.com
 Add: No.1000, Section 2, 2nd Konggang Road, Southwest
 Aviation Industrial Development Zone, Chengdu, Sichuan, China.
 Zip code: 610207

Specifications are subject to change without notice.
 © Blueview™ 2016 – All rights reserved. Made in China.

Specifications

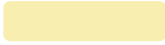
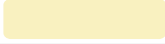
LED Type	SMD 2016	Dimmable	Yes (compatible with BV311 RF dimmer & BV Dimmer)
LED Q'ty/m	266pcs	IP grade	IP22 (IP65 & IP67 & IP68 available upon request)
Input Voltage	24V DC Constant Voltage	Installation	3M™ double sided tape (mounting clips for IP68)
Power	16.42W	Working Temperature	-25~+60°C
Cutting length	26.3mm 7 LEDs	Max run	4 meters
Strip Width	10mm	Certification	E354137 cULus Listed, CE, RoHs
Viewing Angle	120°	Warranty	5 years ^①

Order Code	CCT/ Color	CRI	Lumen/M ^②
FN-2016A-266-24-27K	 2645-2800K	90+	1410
FN-2016A-266-24-30K	 2850-3025K	90+	1410
FN-2016A-266-24-42K	 3840-4060K	90+	1590
FN-2016A-266-24-50K	 4830-5095K	90+	1640
FN-2016A-266-24-65K	 6170-6820K	90+	1640

Note^①: Contact Blueview for exact warranty period and policy

Note^②: Lumen output are based on CRI80+ measured according to PMS-80, with a tolerance of +/- 5%

Note^③: Standard package: 5m/roll

Order Code

Model	Quality level	LED Q'ty/M	Input voltage	CCT/Color
FN	2016A	266	24	25K
FN-IP22 FWS-IP65 FWT-IP67 FWE-IP68	2016A-5 yrs warranty		24-24V DC	view table above for options

BLUEVIEW ELEC-OPTIC TECH CO.,LTD

Tel: +86-28-8148 0011 Fax: +86-28-8148 1258
 Mail: sales@blueviewled.com Web.: www.blueviewled.com
 Add: No.1000, Section 2, 2nd Konggang Road, Southwest
 Aviation Industrial Development Zone, Chengdu, Sichuan, China.
 Zip code: 610207

Specifications are subject to change without notice.
 ©Blueview™ 2016 – All rights reserved. Made in China.

Dimension

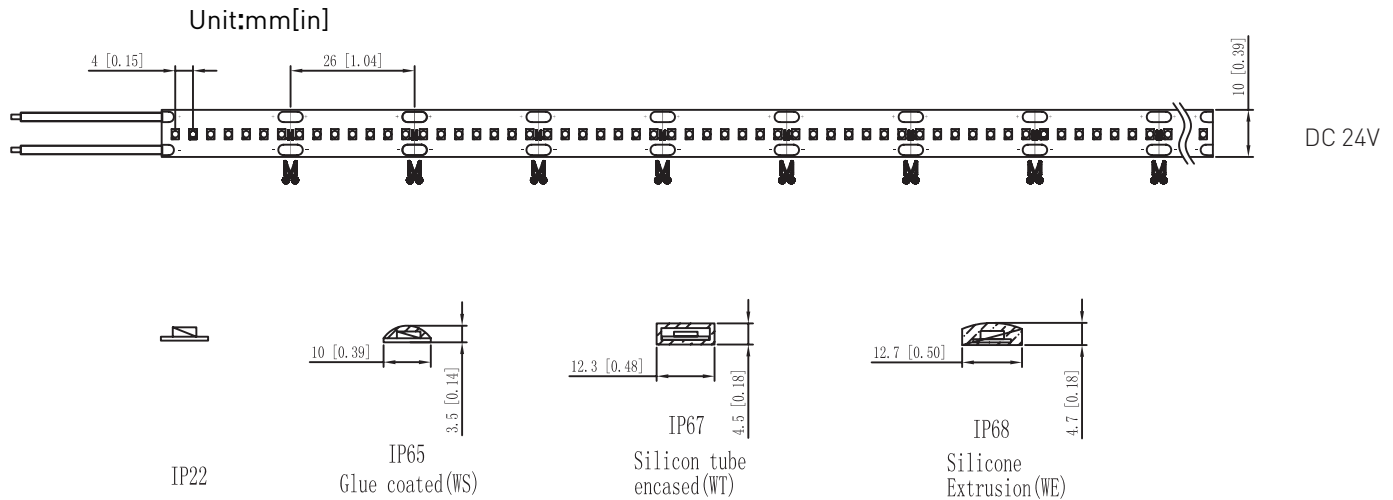

Package

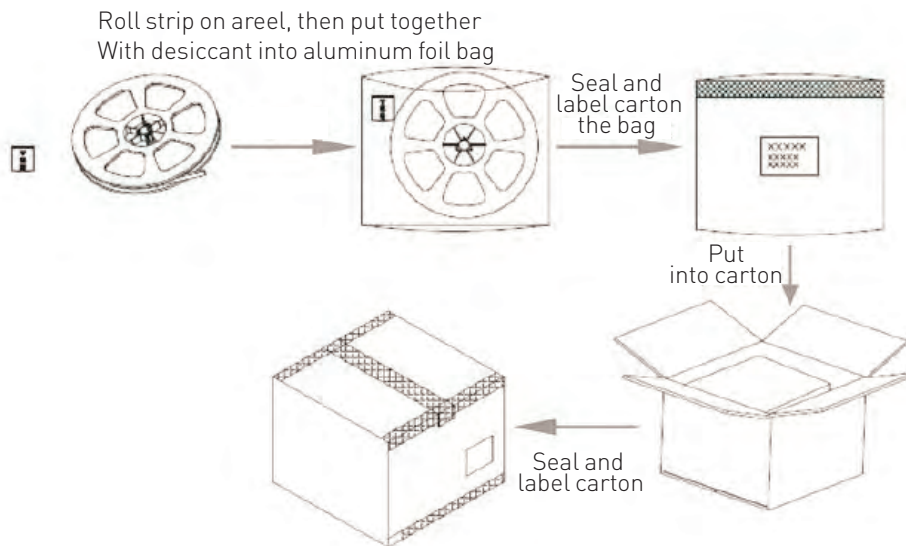

Packing Info

Order Code	Net Weight / CTN	Gross Weight / CTN	Units / CTN	Carton Size
FN-2016A-266-24	12.0 (1±10%) kgs	15.0 (1±10%) kgs	100 rolls	550*400*340mm
FWS-2016A-266-24	25.0 (1±10%) kgs	26.0 (1±10%) kgs	100 rolls	550*400*340mm
FWT-2016A-266-24	25.0 (1±10%) kgs	26.0 (1±10%) kgs	100 rolls	550*400*340mm
FWE-2016A-266-24	30.0 (1±10%) kgs	32.0 (1±10%) kgs	60 rolls	550*400*340mm

BLUEVIEW ELEC-OPTIC TECH CO.,LTD

Tel: +86-28-8148 0011 Fax: +86-28-8148 1258
 Mail: sales@blueviewled.com Web.: www.blueviewled.com
 Add: No.1000, Section 2, 2nd Konggang Road, Southwest
 Aviation Industrial Development Zone, Chengdu,Sichuan, China.
 Zip code: 610207

Specifications are subject to change without notice.
 ©Blueview™ 2016 – All rights reserved. Made in China.