



ChipBrand



One BIN only
for a CCT range



Lifetime



Certified



Certified



Warranty

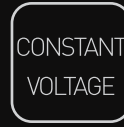

Certified



Certified

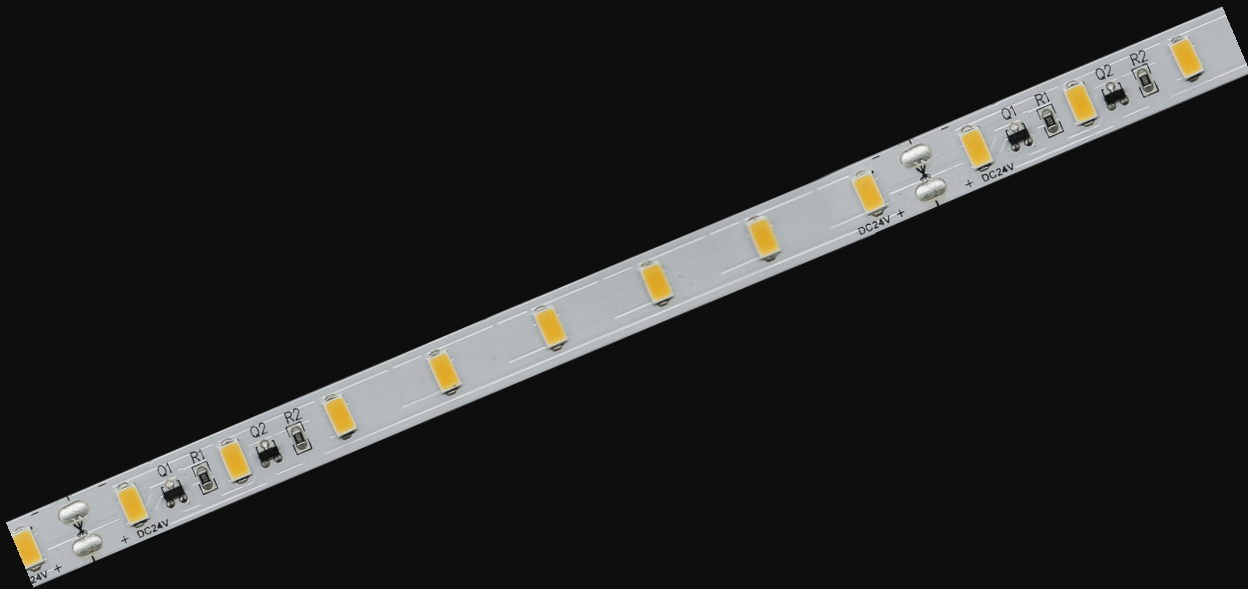

Ra Available



IP Grade Available



Features

- High Light Efficacy
- Constant Voltage 24 VDC system
- Silicone extruded-IP68, Silicone tube encased-IP67, Silicone coated-IP65, indoor-IP22 available
- Epistar chips, LM80 tested
- Ra80+
- CE and RoHS certified
- 3 years warranty







BLUEVIEW ELEC-OPTIC TECH CO.,LTD

Tel: +86-28-8148 0011 Fax: +86-28-8148 1258
 Mail: sales@blueviewled.com Web.: www.blueviewled.com
 Add: No.1000, Section 2, 2nd Konggang Road, Southwest
 Aviation Industrial Development Zone, Chengdu, Sichuan, China.
 Zip code: 610207

Specifications are subject to change without notice.
 © Blueview™ 2017 – All rights reserved. Made in China.

Specifications

LED Type	SMD 5730	Dimmable	Yes (compatible with BV311 RF dimmer & BV Dimmer)
LED Q'ty/m	64pcs	IP grade	IP22 (IP65 & IP67&IP68)
Input Voltage	24V DC Constant Voltage	Installation	Heat-conductive adhesive tape (Heat sink is necessary)
Power	17.28±10%W/m	Working Temperature	-25~+60°C
Cutting length	125mm, 8 LEDs	Max run	5meters(Single Feed)
Strip Width	10mm	Certification	CE, RoHs
Viewing Angle	120°	Warranty	3 years

Order Code	CCT/ Color	Ra	Lumen/M ^②
CN-H5730-64-24-27K	 2700K	80+	2165
CN-H5730-64-24-30K	 3000K	80+	2195
CN-H5730-64-24-35K	 3500K	80+	2220
CN-H5730-64-24-40K	 4000K	80+	2225
CN-H5730-64-24-50K	 5000K	80+	2260
CN-H5730-64-24-65K	 6500K	80+	2282

Note : 1.Lumen output are measured according to PMS-80, with a tolerance of +/- 5%

2. Standard package: 5m/roll

3. The output power must be 24V. Neither higher nor less than 24V to avoid wattage affection on the striplight.

Order Code

Model	Quality level	LED Q'ty/M	Input voltage	CCT/Color
CN	H5730	64	24	27K
CN-IP22 CWS-IP65 CWT-IP67 CWE-IP68	H5730-3 yrs warranty		24V DC	view table above for options

BLUEVIEW ELEC-OPTIC TECH CO.,LTD

Tel: +86-28-8148 0011 Fax: +86-28-8148 1258
 Mail: sales@blueviewled.com Web.: www.blueviewled.com
 Add: No.1000, Section 2, 2nd Konggang Road, Southwest
 Aviation Industrial Development Zone, Chengdu,Sichuan, China.
 Zip code: 610207

Specifications are subject to change without notice.
 ©Blueview™ 2017 – All rights reserved. Made in China.

Dimension

Unit:mm[in]



Package

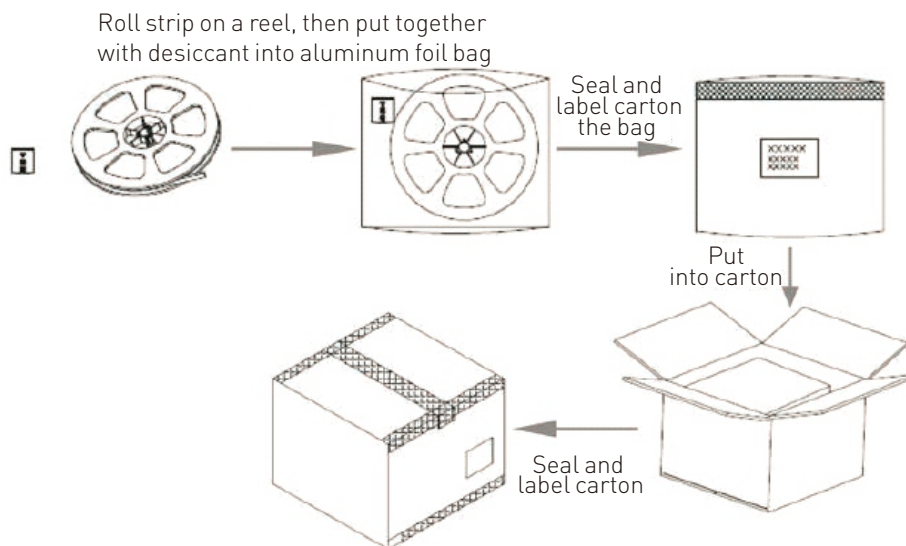

Packing Info

Order Code	Net Weight / CTN	Gross Weight / CTN	Units / CTN	Carton Size
CN-H5730A-64-24	9.05(1±10%)	13.55(1±10%)	100 rolls	550*400*340mm

BLUEVIEW ELEC-OPTIC TECH CO.,LTD

Tel: +86-28-8148 0011 Fax: +86-28-8148 1258
 Mail: sales@blueviewled.com Web.: www.blueviewled.com
 Add: No.1000, Section 2, 2nd Konggang Road, Southwest
 Aviation Industrial Development Zone, Chengdu,Sichuan, China.
 Zip code: 610207

Specifications are subject to change without notice.
 ©Blueview™ 2017 – All rights reserved. Made in China.



ChipBrand



One BIN only
for a CCT range



Lifetime



Certified



Certified



Warranty

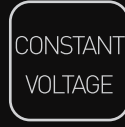

Certified



Certified

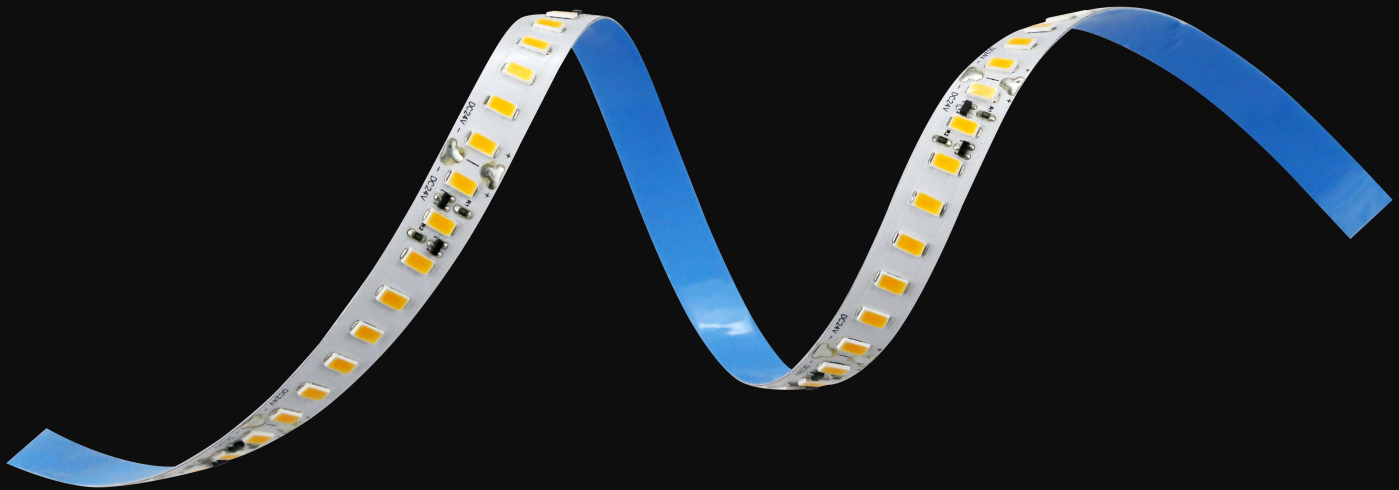

Ra Available



IP Grade Available



Features

- High Light Efficacy
- Constant Voltage 24 VDC system
- Silicone extruded-IP68, Silicone tube encased-IP67, Silicone coated-IP65, indoor-IP22 available
- Epistar chips, LM80 tested
- Ra80+
- CE and RoHS certified
- 3 years warranty







BLUEVIEW ELEC-OPTIC TECH CO.,LTD

Tel: +86-28-8148 0011 Fax: +86-28-8148 1258
 Mail: sales@blueviewled.com Web.: www.blueviewled.com
 Add: No.1000, Section 2, 2nd Konggang Road, Southwest
 Aviation Industrial Development Zone, Chengdu, Sichuan, China.
 Zip code: 610207

Specifications are subject to change without notice.
 © Blueview™ 2017 – All rights reserved. Made in China.

Specifications

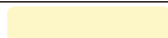
LED Type	SMD 5730	Dimmable	Yes (compatible with BV311 RF dimmer & BV Dimmer)
LED Q'ty/m	128pcs	IP grade	IP22 (IP65 & IP67 & IP68 available upon request)
Input Voltage	24V DC	Installation	Heat-conductive adhesive tape (Heat sink is necessary)
Power	23.04±10%W/m	Working Temperature	-25~+60°C
Cutting length	62.5mm, 8 LEDs	Max run	6.5 meters(Single Feed)
Strip Width	10mm	Certification	CE, RoHs
Viewing Angle	120°	Warranty	3 years

Order Code	CCT/ Color	Ra	Lumen/M ^②
CN-H5730-128-24-27K	 2700K	80+	2660
CN-H5730-128-24-30K	 3000K	80+	2691
CN-H5730-128-24-35K	 3500K	80+	2700
CN-H5730-128-24-40K	 4000K	80+	2727
CN-H5730-128-24-50K	 5000K	80+	2780
CN-H5730-128-24-65K	 6500K	80+	2800

Note^①: The output power must be 24V. Neither higher nor less than 24V to avoid wattage affection to the strip light.

Note^②: Lumen output are measured according to PMS-80, with a tolerance of +/- 5%

Note^③: Standard package: 5m/roll

Order Code

Model	Quality level	LED Q'ty/M	Input voltage	CCT/Color
CN	H5730	128	24	27K
CN-IP22 CWS-IP65 CWT-IP67 CWE-IP68	H5730-3 yrs warranty		24V DC	view table above for options

BLUEVIEW ELEC-OPTIC TECH CO.,LTD

Tel: +86-28-8148 0011 Fax: +86-28-8148 1258
 Mail: sales@blueviewled.com Web.: www.blueviewled.com
 Add: No.1000, Section 2, 2nd Konggang Road, Southwest
 Aviation Industrial Development Zone, Chengdu,Sichuan, China.
 Zip code: 610207

Specifications are subject to change without notice.
 ©Blueview™ 2017 – All rights reserved. Made in China.

Dimension

Unit:mm[in]



Package

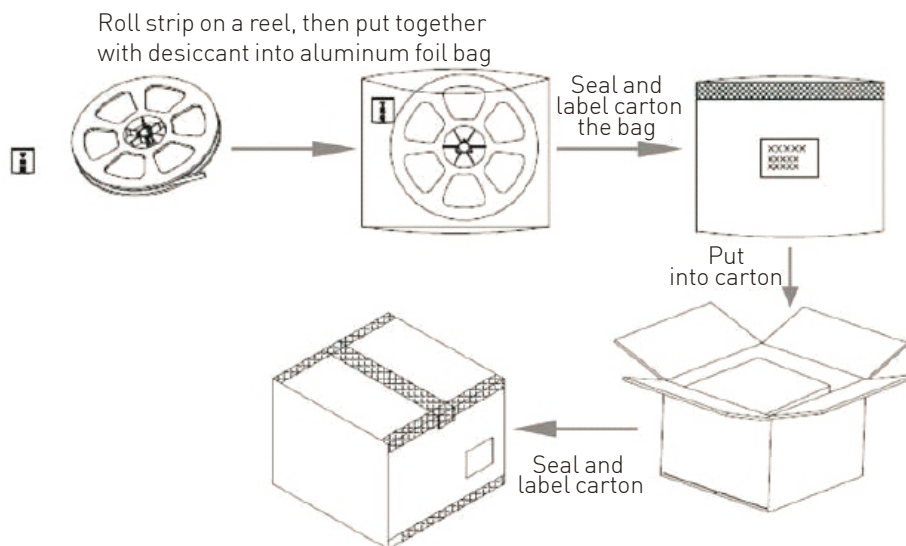

Packing Info

Order Code	Net Weight / CTN	Gross Weight / CTN	Units / CTN	Carton Size
CN-H5730A-128-24	9.55(1±10%) kg	14.05(1±10%) kg	100 rolls	550*400*340mm

BLUEVIEW ELEC-OPTIC TECH CO.,LTD

Tel: +86-28-8148 0011 Fax: +86-28-8148 1258
 Mail: sales@blueviewled.com Web.: www.blueviewled.com
 Add: No.1000, Section 2, 2nd Konggang Road, Southwest
 Aviation Industrial Development Zone, Chengdu,Sichuan, China.
 Zip code: 610207

Specifications are subject to change without notice.
 ©Blueview™ 2017 – All rights reserved. Made in China.